

Cast Iron Foot Valve Screwed BSPT

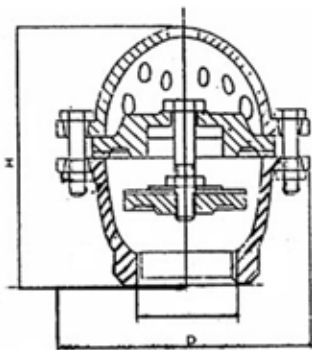

Application :

The valve is fitted at the end of the pipe of water pump, which can avoid adverse current and prevent foreign substance from being drawn into pump. It is suitable for use on water.

Scope of Application

Nominal Pressure PN	6 bar
Strength Pressure	9 bar
Seal Test Pressure	10 bar
Suitable Temperature	< 60°C
Suitable Medium	water

Dimension

mm

SIZE	D	H	WT.(KG)
15	62	60	0.26
20	78	76	0.375
25	94	90	0.7
32	101	101	0.86
40	116	107	1.25
50	145	130	2.2
65	170	155	3.3
80	200	185	6.3
100	247	228.5	14.25

Cast Iron Foot Valve Flanged End JIS 10K

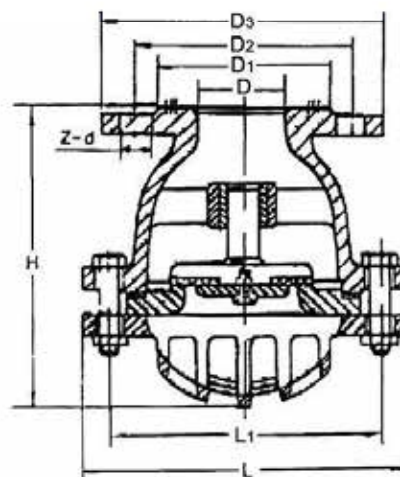

Scope of Application

Nominal Pressure PN	6 bar
Strength Pressure	9 bar
Seal Test Pressure	10 bar
Suitable Temperature	< 60°C
Suitable Medium	water

Application :

The valve is fitted at the end of the pipe of water pump, which can avoid adverse current and prevent foreign substance from being drawn into pump. It is suitable for use on water.

Dimension

mm

Nominal Diameter DN	L	L1	H	D	D1	D2	D3	Z-d	WT kg
1.5"	154	128	150	40	80	105	130	4-Φ14	7
2"	154	128	150	50	90	120	140	4-Φ14	7
2.5"	170	146	170	65	110	140	160	4-Φ14	8
3"	198	174	210	80	125	150	185	4-Φ18	10
4"	250	222	240	100	145	175	205	4-Φ18	17
5"	300	270	280	125	170	210	235	8-Φ18	25
6"	331	302	346	150	190	240	260	8-Φ18	32.5
8"	426	394	395	200	255	290	315	8-Φ18	53.5
10"	480	445	445	250	310	355	370	12-Φ18	78
12"	548	506	510	300	362	400	435	12-Φ23	110

Cast Iron Foot Valve Flanged End JIS 10K

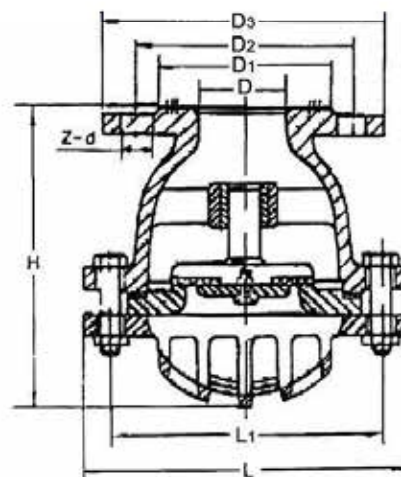

Scope of Application

Nominal Pressure PN	6 bar
Strength Pressure	9 bar
Seal Test Pressure	10 bar
Suitable Temperature	< 60°C
Suitable Medium	water

Application :

The valve is fitted at the end of the pipe of water pump, which can avoid adverse current and prevent foreign substance from being drawn into pump. It is suitable for use on water.

Dimension

mm

Nominal Diameter DN	L	L1	H	D	D1	D2	D3	Z-d	WT kg
1.5"	154	128	150	40	80	105	130	4-Φ14	7
2"	154	128	150	50	90	120	140	4-Φ14	7
2.5"	170	146	170	65	110	140	160	4-Φ14	8
3"	198	174	210	80	125	150	185	4-Φ18	10
4"	250	222	240	100	145	175	205	4-Φ18	17
5"	300	270	280	125	170	210	235	8-Φ18	25
6"	331	302	346	150	190	240	260	8-Φ18	32.5
8"	426	394	395	200	255	290	315	8-Φ18	53.5
10"	480	445	445	250	310	355	370	12-Φ18	78
12"	548	506	510	300	362	400	435	12-Φ23	110

STAINLESS STEEL FOOT VALVE SCREWED END

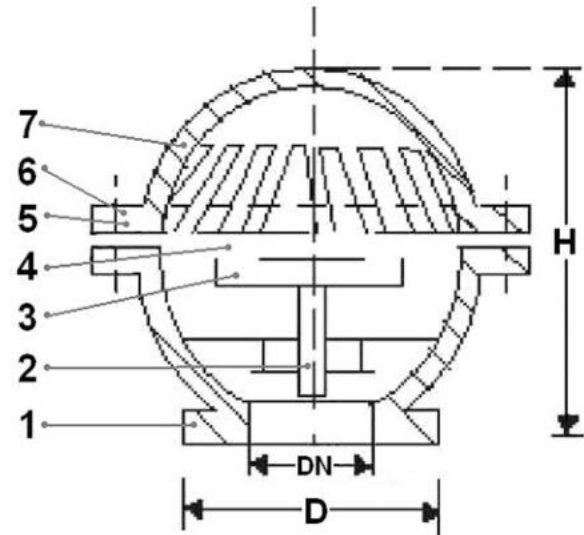

Technical Data

Dimension in mm

SIZES		D	H	WT. (KG)
DN	in.			
15	1/2	45	100	0.8
20	3/4	45	100	0.8
25	1	48	105	0.9
32	1.1/4	58	107	1.2
40	1.1/2	58	109	1.4
50	2	70	135	2.2

Material

No.	PART	MATERIAL
1	BODY	SUS 304 / SUS 316
2	STEM	SUS 304 / SUS 316
3	DISC	SUS 304 / SUS 316
4	GASKET	PTFE
5	BOLT	SUS 304 / SUS 316
6	NUT	SUS 304 / SUS 316
7	SCREEN	SUS 304 / SUS 316

Features

Designed for use in irrigation and other pumping applications where water may be dirty due to suspended silt and sand. BSPT threaded ends for easy installation.

STAINLESS STEEL FOOT VALVE FLANGED END JIS 10K

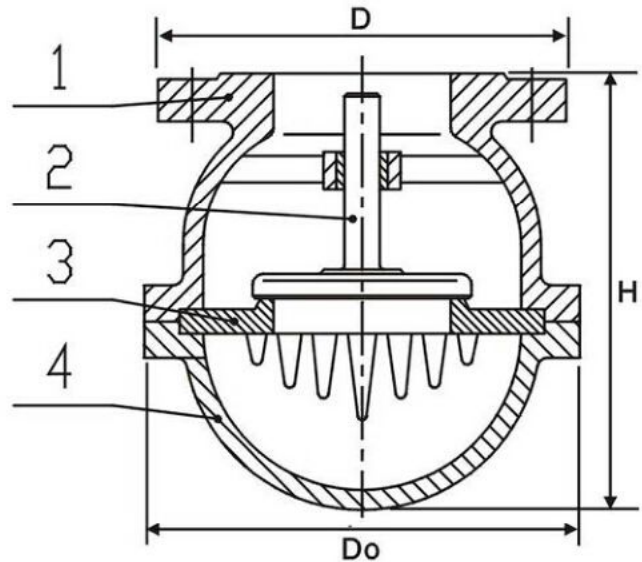

Features :

The stainless steel foot valve is fitted at the end of the pipe of water pump, which can avoid adverse current and prevent foreign substance from being drawn into pump. It is suitable for use on water, oil and gas.

Dimension in mm

SIZES		D	Do	H
DN	in.			
50	2	140	145	105
65	2.1/2	160	170	150
80	3	185	195	190
100	4	205	215	210
150	6	260	280	270
200	8	320	370	360
250	10	375	390	410

Technical Data

Material

No.	PART	MATERIAL
1	BODY	STAINLESS STEEL
2	SEAT	STAINLESS STEEL
3	DISC	STAINLESS STEEL
4	COVER	STAINLESS STEEL

Suitable Temperature : < 80°C

